



TO FIT

# VÄDERSTAD (SEED HAWK)

## SEED HAWK INLINE SEEDING SYSTEM

"The trash clearance was phenomenal with my Dutch Inline Seed Shanks to fit Seed Hawk. I never had to lift my shanks up once during seeding, which was a complete day and night difference from my OEM openers. The seed placement was exactly where I set it to be even in tough seeding conditions."

**ROB KAAKE - HAZLET, SK**

### OEM OFFSET DESIGN

TRASH VULNERABLE

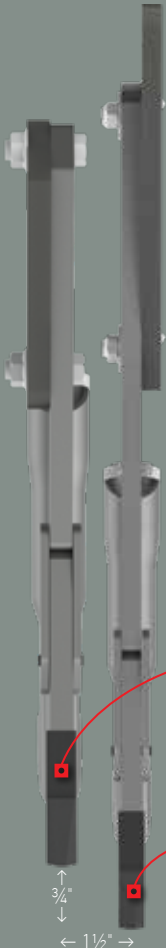

### DUTCH AGRICULTURE'S INLINE DESIGN

TRASH RESISTANT

THE ORIGINAL INLINE SEEDING SYSTEM



SEED SHANK

FERTILIZER SHANK

- ### Product Highlights
- **Inline system clears trash and eliminates the clumping and dumping compared to OEM**
  - Allows you to easily switch between side-band and paired row tips
  - Seed delivery directly behind the cutting edge allows for near perfect seed placement
  - Liquid starter fertilizer tubes available

"We have run the Dutch Inline seed knives for 2 seasons with no plugging and no trash buildup between the shanks, and the flow of trash and soil is excellent. Seed placement is perfect and with around 15,000 acres on the tips, we see no reason to change them as they wear very well."

**GRAHAM DOUGLASS - BASSANO, AB**



**DUTCH**  
**AGRICULTURE**  
QUALITY FOR GENERATIONS™

## CONTACT DETAILS

### HEAD OFFICE

#### Dutch Industries

P.O. Box 568 - 500 Portico Drive  
Pilot Butte, SK, Canada S0G 3Z0

**TF** 1.800.663.8824

**PH** 306.781.4820

**Fax** 306.781.4877

[sales@dutchopeners.com](mailto:sales@dutchopeners.com)

[dutchind.com](http://dutchind.com)

[dutchopeners.com](http://dutchopeners.com)

[dutchopeners.com.au](http://dutchopeners.com.au)

[dutchopeners.uk](http://dutchopeners.uk)

[biospreader.com](http://biospreader.com)

[dutchmanufacturing.com](http://dutchmanufacturing.com)

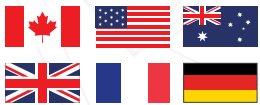

### FOLLOW US ON SOCIAL MEDIA

 [Dutch Openers](#)

 [@DutchOpeners](#)

 [Dutch Industries Ltd.](#)

 [@DutchIndustries](#)

 [Dutch Agriculture](#)

### CANADIAN AGRICULTURAL TERRITORY MANAGERS

#### Northern Alberta & British Columbia

Chris Lupul  
Cell 780.632.1919  
[clupul@dutchopeners.com](mailto:clupul@dutchopeners.com)

#### Southern Alberta

Terence Peatman  
Cell 403.501.1998  
[tpeatman@dutchopeners.com](mailto:tpeatman@dutchopeners.com)

#### Northern Saskatchewan & Northern Manitoba

Connor Bohachewski  
Cell 306.921.7715  
[cbohachewski@dutchopeners.com](mailto:cbohachewski@dutchopeners.com)

#### Southern Saskatchewan & Southern Manitoba

Andrew Sanderson  
Cell 306.551.7171  
[asanderson@dutchopeners.com](mailto:asanderson@dutchopeners.com)

### USA AGRICULTURAL TERRITORY MANAGERS

#### USA Eastern

Tom Wible (ND, SD, MT, NE, MN, WI)  
Cell 605.360.4385  
[twible@dutchopeners.com](mailto:twible@dutchopeners.com)

#### USA Western

Terence Peatman (WA, OR, ID)  
Cell 403.501.1998  
[tpeatman@dutchopeners.com](mailto:tpeatman@dutchopeners.com)

### DUTCH SERVICE GUARANTEE

We guarantee that you will receive  
the best service in the industry  
from our sales and engineering  
team.

On-site assistance is only  
a phone call away at  
**1.800.66.DUTCH**